

No dimensions to be scaled off this drawing.

All dimensions to be checked on site before work commences and any discrepancies reported to the architect.

This drawing to be read in conjunction with other drawings issued by the architect.

Notes

New glazed external door

Lower floor to chancel to match nave with single step to altar platform and re-used timber paneling to line walls

New raised floor finish to nave, tower, aisles & into chancel in engineered oak boarding with stone altar platform

Relocate reredos to east wall and lower in height. Infill panels in matching timber

Remove rood screen but keep cross & beam and suspend higher in chancel arch

Remove pews & provide pew chairs for adaptable layout and forward altar, reader's desks and new lectern

New twin gas boilers and panel radiators to heat church - design by specialist
Add heating to porch

New up and downlights to nave, aisles and chancel with additional spots - All LED

New sound and projection systems with motorised foldaway screen to rear rood beam

New clear glazing to leaded lights to tower screen.
New storage cupboards and desk improve access to tower & organ

Redecorate throughout

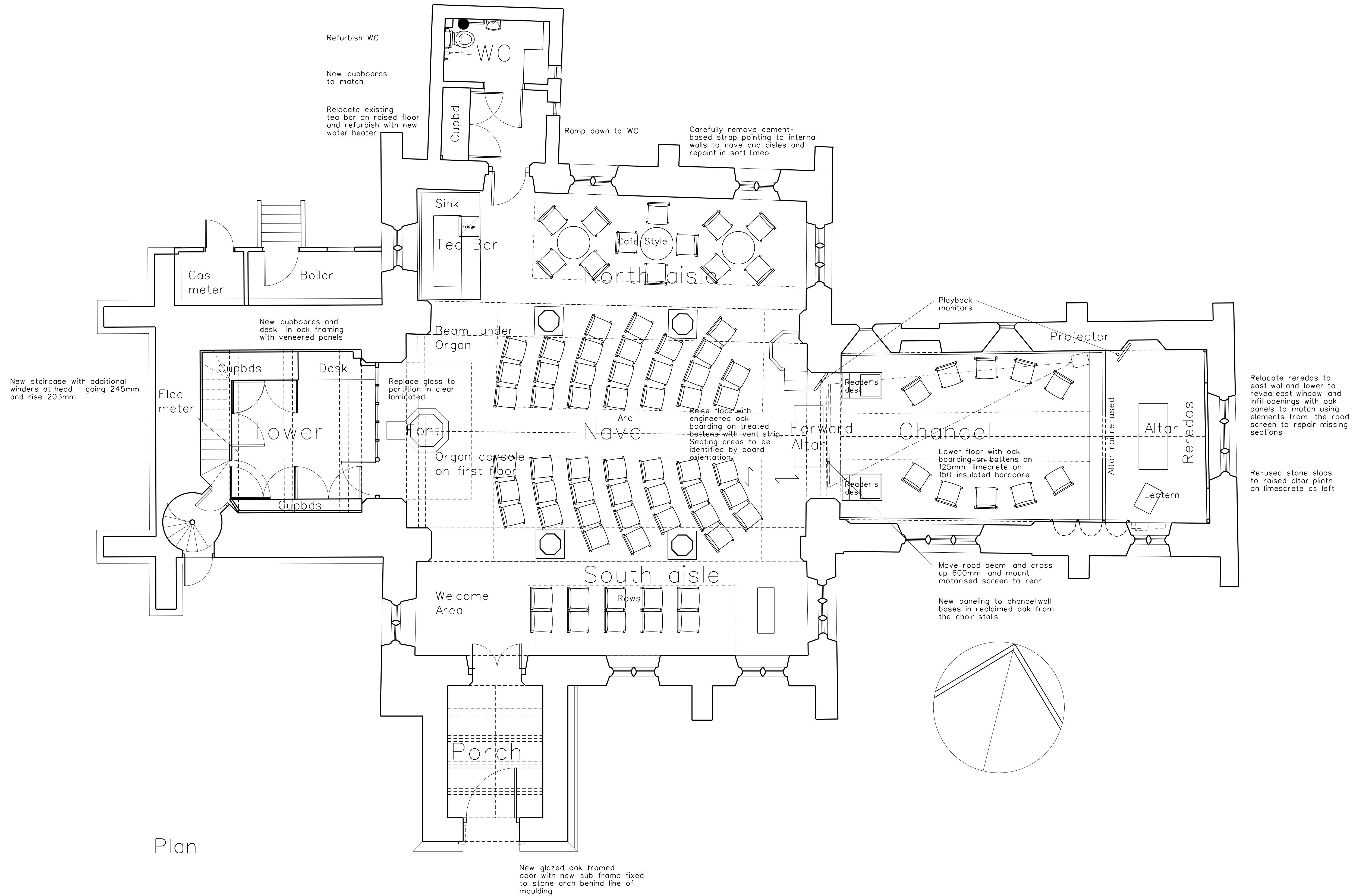

Plan

| Rev. | Date | Initials |
|------|------|----------|
| | | |

Notes

MARK GOODWILL-HODGSON LTD
Specialist Conservation Architect
1 Highfield Road West Bridgford
Nottingham NG2 6DR 07970 692 887
markgoodwillhodgson@gmail.com

Client
St Helens PCC
Trowell

Job
Re-ordering

Drawing
Proposed plan

| Job Number | Drawing Number | Revision |
|------------|----------------|----------|
| pr1440 | L(2)101 | |
| Scale | Status | Date |
| 1:50 | feasibility | 30.01.15 |